

WELCOME TO MIDTOWN

مرحباً بكم في ميدتاون

يوفر لكم ميدتاون فرصة سكن فريدة من نوعها. حيث تجتمع خبرة البناء والتطوير مع الحرفة المعمارية. هذا المجمع المتكامل يحمل بصمة (ديار) حيث يضم مجمعاً سكنياً، ومجموعة من وسائل الراحة والخدمات المختارة بعناية، ومجموعة من المتاجر والمطاعم، بالإضافة إلى المسطحات الخضراء، وكل ذلك ضمن مساحة تقارب ٥ ملايين قدم مربع.



Where development expertise meets architectural mastery, Midtown welcomes you to a unique living experience. This signature township by Deyaar hosts a residential complex with an array of thoughtful amenities, retail services and dining options. Resting along the beautifully landscaped piazza, these amenities are spread over a sprawling 5 million square feet of development.

ABOUT DANIA DISTRICT

عن دانية ديستركت



دانية ديستركت DANIA DISTRICT

تستقبلكم دانية ديستركت في وسط مجمع ميدتاون، في أبنيتها الستة المذهلة، والتي تنبض بمستوى حياة متميز، حيث صممت دانية لتلبي جميع متطلبات الحياة العصرية عبر منازل مصممة بعناية، مسطحات خضراء، ملعب كرة سلة، ملعب تنس وغيرها الكثير، احجز منزلك الآن ليكون كل يوم تعيشه فيه ذكرى مميزة.

Dania District, a slice of paradise in the heart of Midtown, welcomes you to six magnificent buildings boasting the finest of lifestyle options. With beautifully designed homes, open lawns, a basketball court, tennis courts and more, Dania District is designed to suit all your lifestyle needs. So book your home today and make every day, a day to remember.



IMPZ

N
SH. MOHAMMED BIN
ZAYED ROAD



دانية ديستركت
DANIA DISTRICT

JUMEIRAH GOLF
ESTATES

- 1 ملعب تنس
TENNIS COURT
- 2 بركة سباحة عائلية
FAMILY SWIMMING POOL
- 3 بركة سباحة للأطفال
CHILDREN'S POOL
- 4 غرف التبديل
CHANGING FACILITIES
- 5 منطقة ألعاب للأطفال / رياضة في الهواء الطلق
CHILDREN'S PLAY AREA/OUTDOOR SPORT
- 6 مضمار الجري
JOGGING TRACK
- 7 ملعب لكرة السلة
BASKETBALL COURT

- 8 مسطحات خضراء / منطقة فعاليات
OPEN LAWN/EVENTS SPACE
- 9 محلات تجزئة ومطاعم
RETAIL - F&B OUTLETS
- 10 منطقة ترفيهية مع جدار للتسلق
RECREATIONAL AREA WITH CLIMBING WALL

- 11 مواقف الزوار
VISITORS PARKING
- 12 مدخل مواقف السكان
RESIDENTS PARKING ENTRANCE
- 13 ممشى الحديقة المركزية
CENTRAL GARDEN WALK

مخطط الطابق FLOOR PLANS

إخلاء مسؤولية:

(1) جميع المعلومات والمواد والمخططات والمرافق الواردة هي تقريبية ووضعت لغايات العرض فقط. للمطور الحق في مراجعة المخططات والموصفات والمواد والقياسات والرسومات والمرافق المعروضة دون إشعار مسبق. (2) مساحات الوحدات والأبعاد الحقيقية والمخططات ومواقع ومواصفات الشرفات والأبواب والخزائن أو أية تجهيزات أخرى قد تختلف من طابق إلى آخر أو من وحدة إلى أخرى وهي خاضعة للتعديل من قبل المطور. (3) لن يتم توفير أي أثاث أو أجهزة كهربائية من قبل المطور.

Disclaimers:

(1) All information, materials, plans and amenities are approximate and provided for illustrative purposes only. The developer reserves the right to make revisions to the floor plans and any features, materials, dimensions, drawings and amenities of the project without notice. (2) Units areas, actual dimensions, layout, location, specifications of balcony, door, wardrobe or other fixtures may vary from floor to floor and between units and are subject to revision by the developer. (3) Furniture and electric devices will not be provided by the developer.

DANIA 2 & 3
STUDIO APARTMENT - TYPE B & C

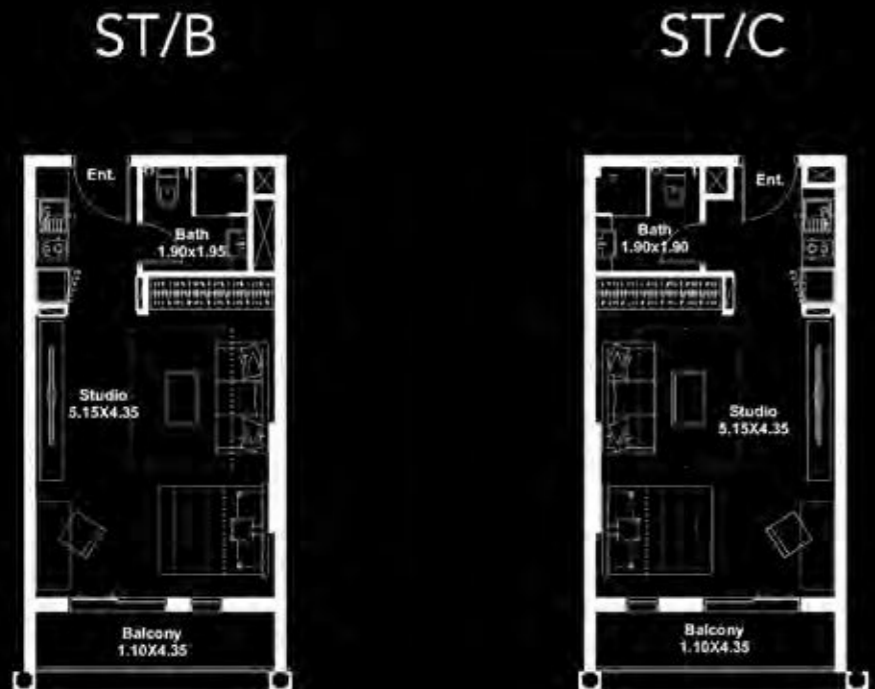

| TYPE | UNIT NO. | LEVEL | UNIT (SQ.FT.) | BALCONY (SQ.FT.) | TOTAL (SQ.FT.) | TOTAL COUNT (NO.) |
|------|----------|-------|---------------|------------------|----------------|-------------------|
| ST/B | 05 & 08 | 9-16 | 382 | 56 | 438 | 32 |
| ST/C | 06 & 07 | 9-16 | 388 | 56 | 444 | 32 |

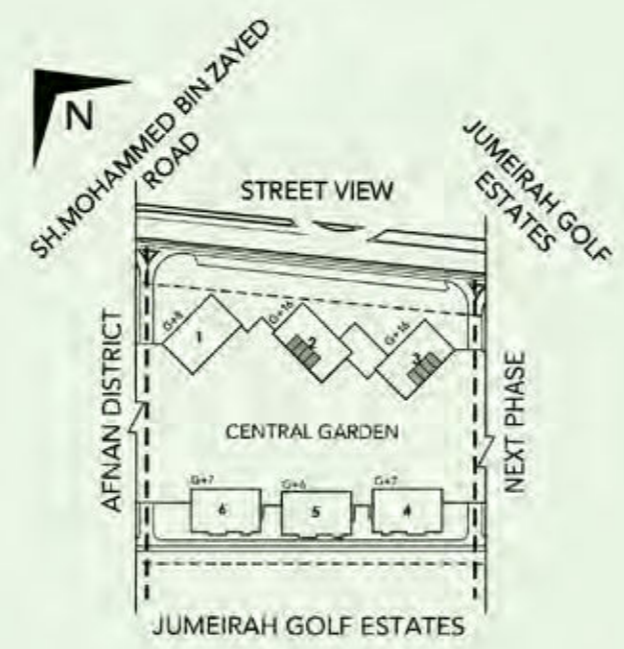

DANIA 2 & 3

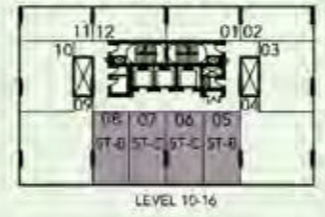

DANIA 2 & 3

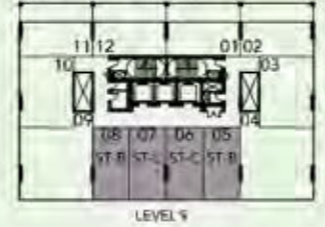

DANIA 2 & 3
STUDIO APARTMENT - TYPE D & E



| TYPE | UNIT NO. | LEVEL | UNIT (SQ.FT.) | BALCONY (SQ.FT.) | TOTAL (SQ.FT.) | TOTAL COUNT (NO.) |
|------|----------|-------|---------------|------------------|----------------|-------------------|
| ST/D | 01 & 12 | 9 | 427 | 240 | 667 | 4 |
| ST/E | 02 & 11 | 9 | 431 | 248 | 679 | 4 |

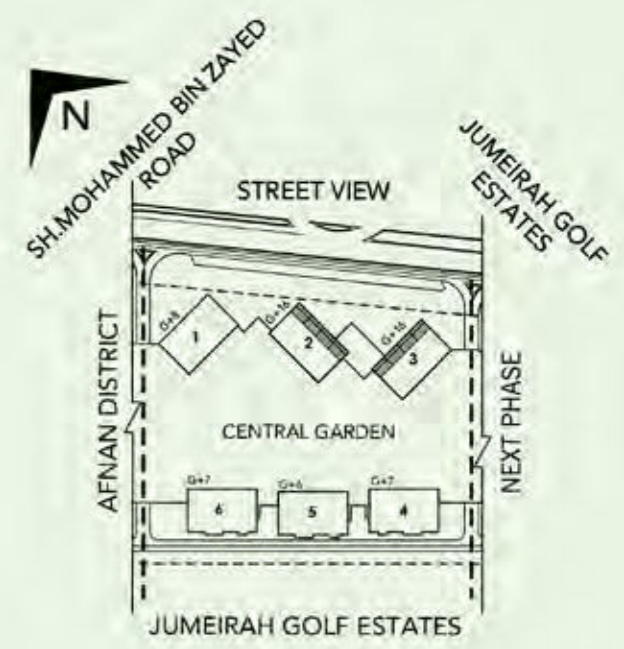

DANIA 2 & 3

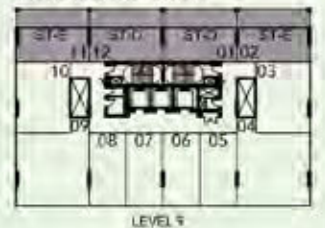

DANIA 2 & 3
STUDIO APARTMENT - TYPE F & G

ST/F

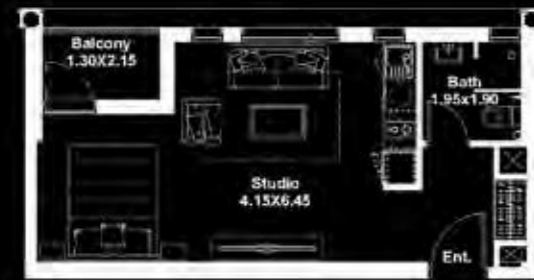

ST/G



| TYPE | UNIT NO. | LEVEL | UNIT (SQ.FT.) | BALCONY (SQ.FT.) | TOTAL (SQ.FT.) | TOTAL COUNT (NO.) |
|------|----------|-------|---------------|------------------|----------------|-------------------|
| ST/F | 01 & 12 | 10-16 | 392 | 37 | 429 | 28 |
| ST/G | 02 & 11 | 10-16 | 394 | 37 | 431 | 28 |

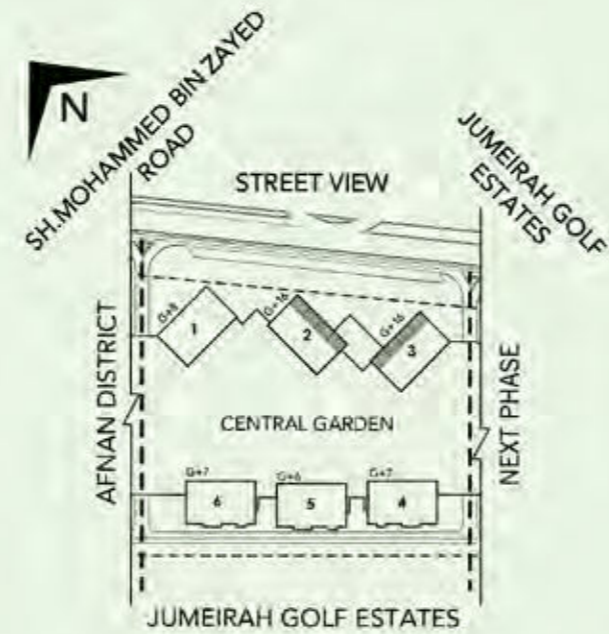

DANIA 2 & 3

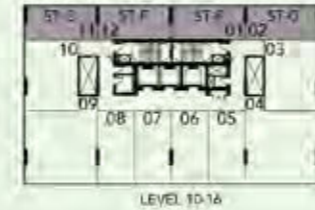

DANIA 1, 2 & 3
STUDIO APARTMENT - TYPE H

ST/H



| TYPE | UNIT NO. | LEVEL | UNIT (SQ.FT.) | BALCONY (SQ.FT.) | TOTAL (SQ.FT.) | TOTAL COUNT (NO.) |
|------|-----------------|-------|---------------|------------------|----------------|-------------------|
| ST/H | 07 (BLDG 1 & 3) | 1 | 496 | 236 | 732 | 2 |
| | 04 (BLDG 2) | 1 | 496 | 236 | 732 | 1 |

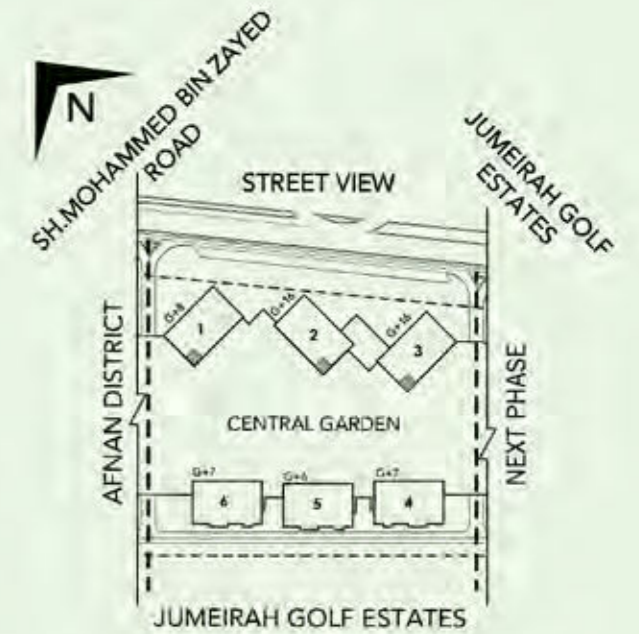

DANIA 1 & 3



DANIA 2

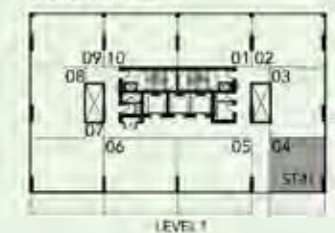

DANIA 1, 2 & 3
ONE BEDROOM APARTMENT - TYPE A & F

1BR/A

1BR/F



| TYPE | UNIT NO. | LEVEL | UNIT (SQ.FT.) | BALCONY (SQ.FT.) | TOTAL (SQ.FT.) | TOTAL COUNT (NO.) |
|-------|-----------------|-------|---------------|------------------|----------------|-------------------|
| 1BR/A | 04 & 07 | 2-8 | 666 | 53 | 719 | 42 |
| 1BR/F | 04 (BLDG 1 & 3) | 1 | 716 | 322 | 1,038 | 2 |
| 1BR/F | 07 (BLDG 2) | 1 | 716 | 322 | 1,038 | 1 |

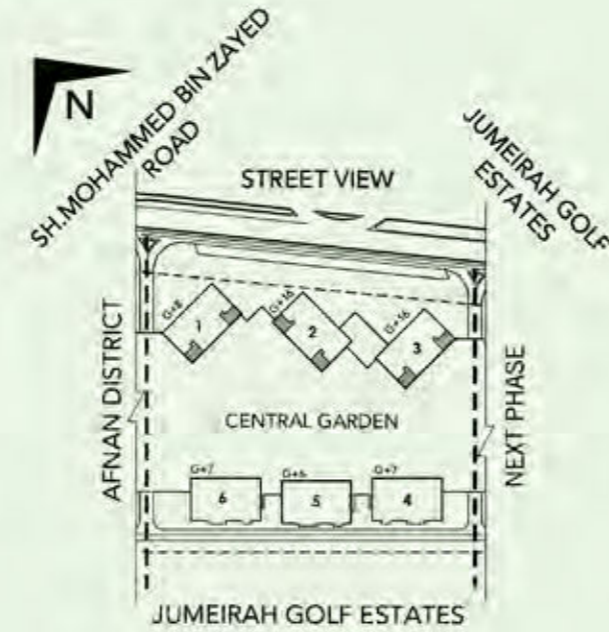

DANIA 1,2 & 3

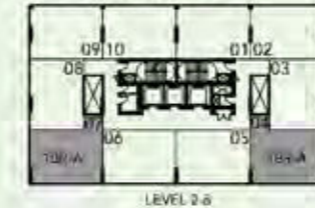

DANIA 1 & 3

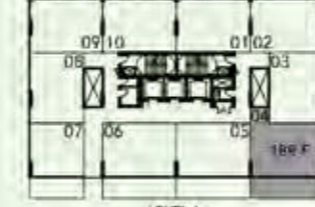

DANIA 2

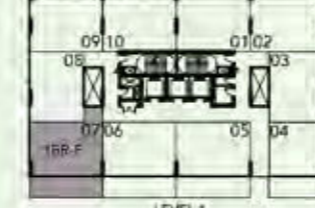

DANIA 1,2 & 3
ONE BEDROOM APARTMENT - TYPE B & C

1BR/B

1BR/C

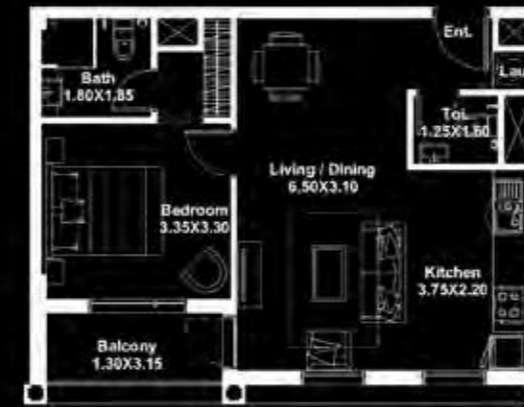

| TYPE | UNIT NO. | LEVEL | UNIT (SQ.FT.) | BALCONY (SQ.FT.) | TOTAL (SQ.FT.) | TOTAL COUNT (NO.) |
|-------|------------|-------|---------------|------------------|----------------|-------------------|
| 1BR/B | 01 & 10 | 1-8 | 605 | 51 | 656 | 48 |
| 1BR/B | 05 & 06 | 2-8 | 593 | 51 | 644 | 42 |
| 1BR/C | 03 & 08/10 | 1-16 | 576 | 50 | 626 | 80 |

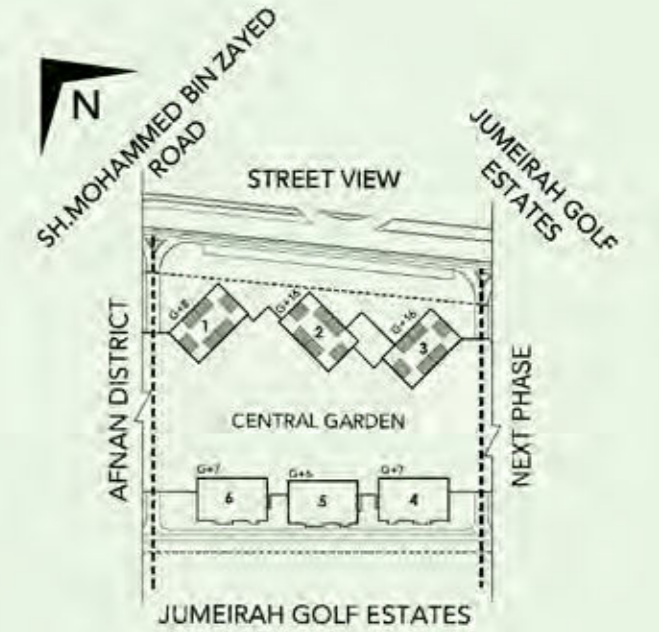

DANIA 2 & 3

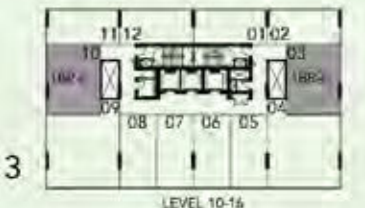

DANIA 2 & 3

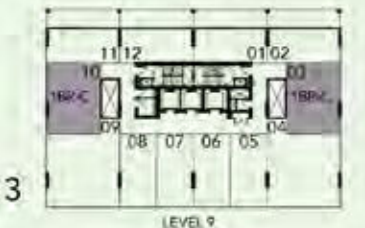

DANIA 1,2 & 3

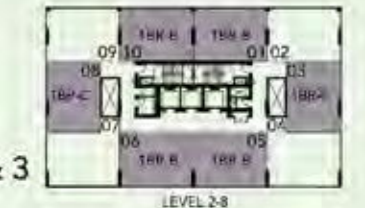

DANIA 1,2 & 3

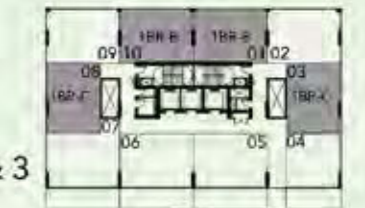

DANIA 1, 2 & 3
ONE BEDROOM APARTMENT - TYPE D & E

1BR/D

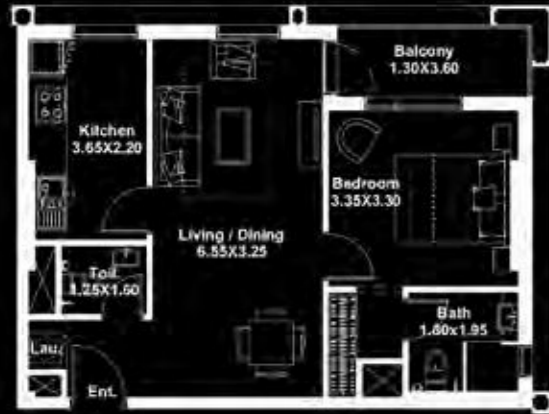

1BR/E

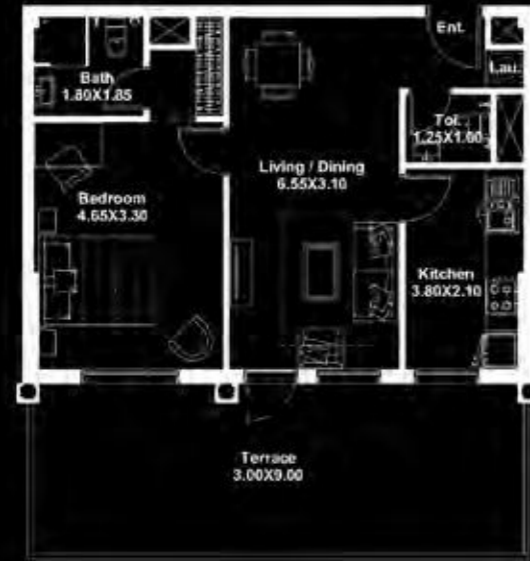

| TYPE | UNIT NO. | LEVEL | UNIT (SQ.FT.) | BALCONY (SQ.FT.) | TOTAL (SQ.FT.) | TOTAL COUNT (NO.) |
|-------|----------|-------|---------------|------------------|----------------|-------------------|
| 1BR/D | 02 & 09 | 1-8 | 610 | 54 | 664 | 48 |
| 1BR/E | 05 & 06 | 1 | 644 | 317 | 961 | 6 |

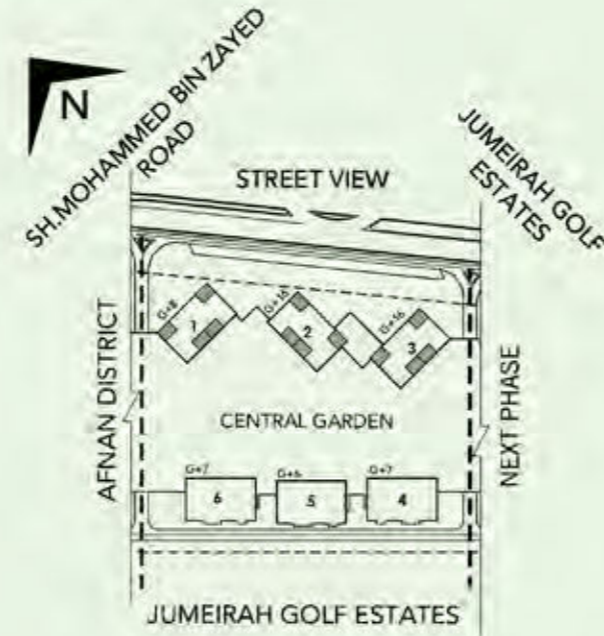

DANIA 1,2 & 3

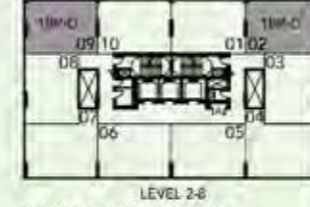

DANIA 1,2 & 3

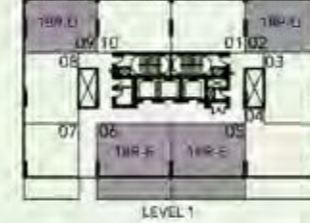

DANIA 4, 5 & 6
ONE BEDROOM APARTMENT - TYPE G

1BR/G



| TYPE | UNIT NO. | LEVEL | UNIT (SQ.FT.) | BALCONY (SQ.FT.) | TOTAL (SQ.FT.) | TOTAL COUNT (NO.) |
|-------|-------------|-------|---------------|------------------|----------------|-------------------|
| 1BR/G | 05, 10 & 17 | 2-4 | 677 | 95 | 772 | 9 |

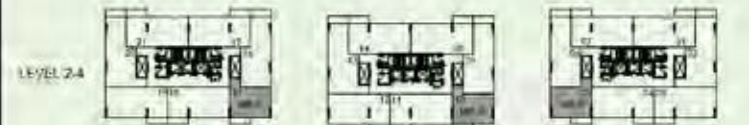
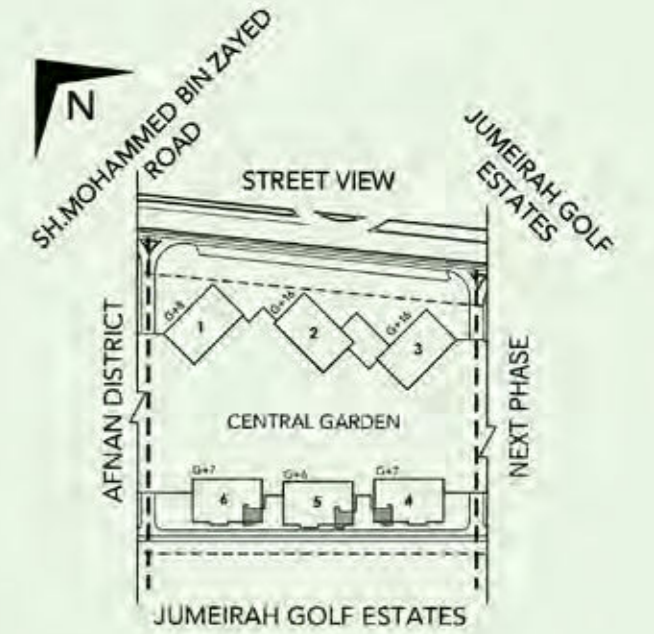

DANIA 6

DANIA 5

DANIA 4

DANIA 4, 5 & 6
ONE BEDROOM APARTMENT - TYPE H

1BR/H



| TYPE | UNIT NO. | LEVEL | UNIT (SQ.FT.) | BALCONY (SQ.FT.) | TOTAL (SQ.FT.) | TOTAL COUNT (NO.) |
|-------|-------------|-------|---------------|------------------|----------------|-------------------|
| 1BR/H | 03, 04 & 07 | M | 644 | 95 | 739 | 8 |
| | 05, 10 & 17 | 1 | | | | |
| | 05 & 08 | 7 | | | | |
| | 05, 10 & 17 | 5, 6 | 639 | 95 | 734 | 6 |

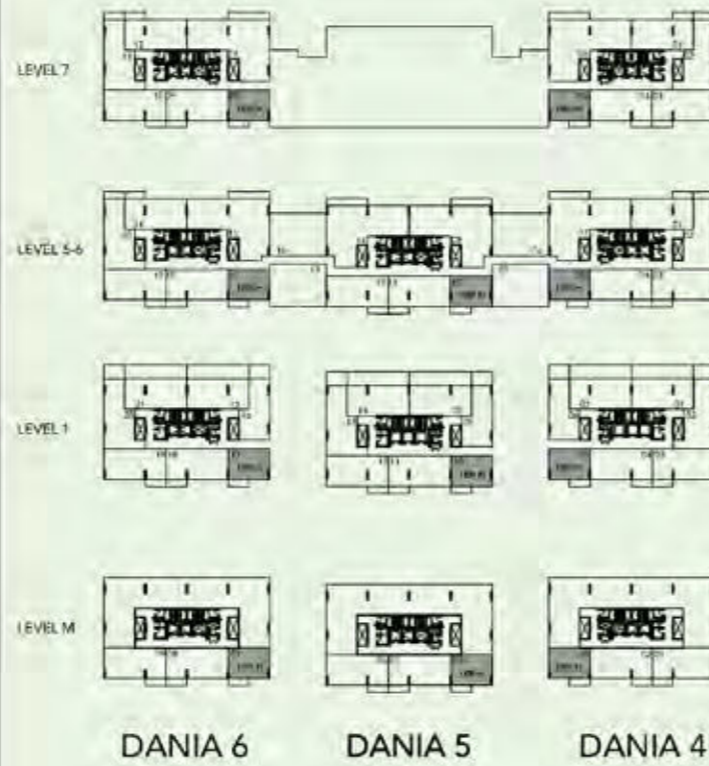
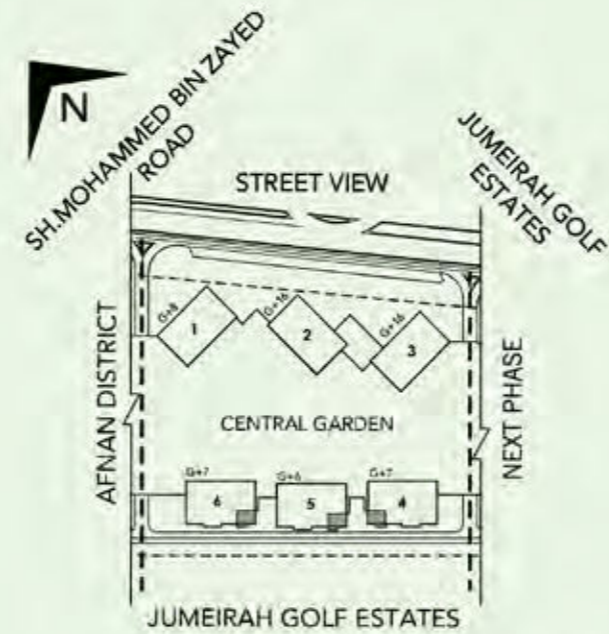

DANIA 4, 5 & 6
ONE BEDROOM APARTMENT - TYPE I

1BR/I



| TYPE | UNIT NO. | LEVEL | UNIT (SQ.FT.) | BALCONY (SQ.FT.) | TOTAL (SQ.FT.) | TOTAL COUNT (NO.) |
|-------|-------------|-------|---------------|------------------|----------------|-------------------|
| 1BR/I | 06, 09 & 16 | 1 | 821 | 150 | 971 | 3 |

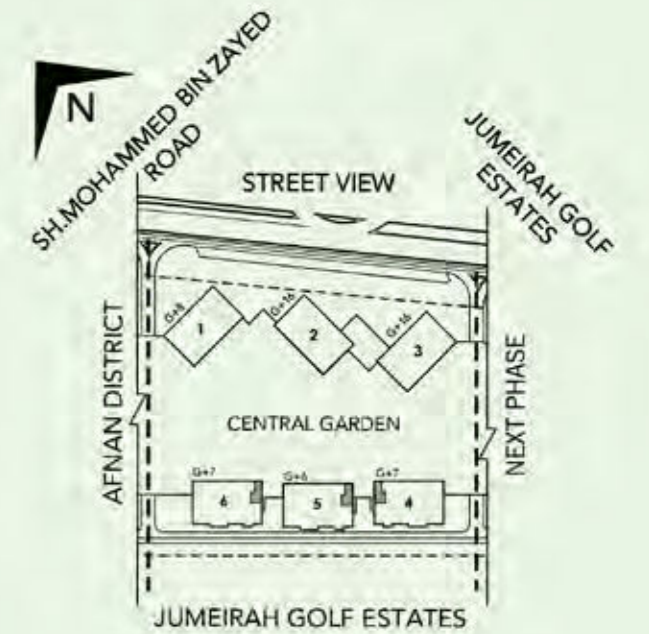

DANIA 2 & 3
TWO BEDROOM APARTMENT - TYPE A

2BR/A



| TYPE | UNIT NO. | LEVEL | UNIT (SQ.FT.) | BALCONY (SQ.FT.) | TOTAL (SQ.FT.) | TOTAL COUNT (NO.) |
|-------|----------|-------|---------------|------------------|----------------|-------------------|
| 2BR/A | 04 & 09 | 9-16 | 904 | 69 | 973 | 32 |

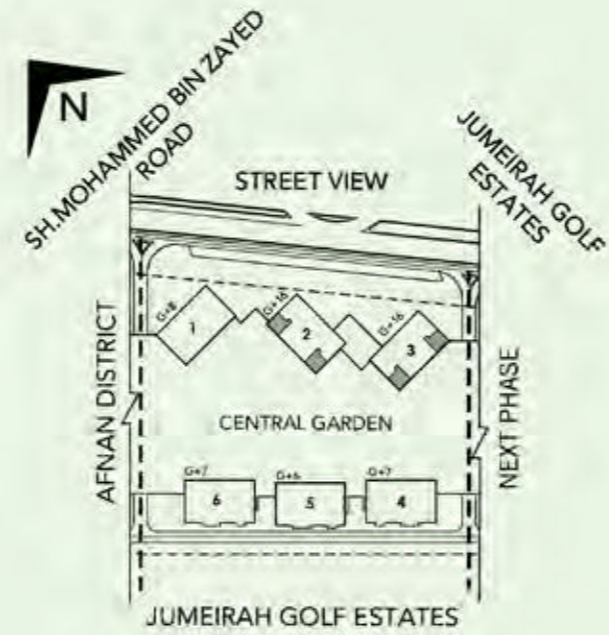

DANIA 2 & 3

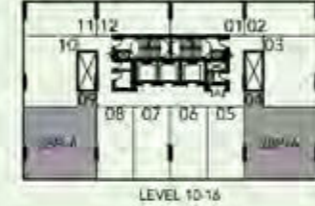

DANIA 2 & 3

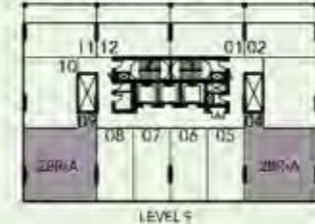

DANIA 4, 5 & 6
TWO BEDROOM APARTMENT - TYPE B

2BR/B



| TYPE | UNIT NO. | LEVEL | UNIT (SQ.FT.) | BALCONY (SQ.FT.) | TOTAL (SQ.FT.) | TOTAL COUNT (NO.) |
|---------|-------------------------|-------|---------------|------------------|----------------|-------------------|
| 2BR/B | 01, 06 & 09 | M | 962 | 99 | 1,061 | 17 |
| | 03 & 19 | 1-6 | | | | |
| | 03 & 10 | 7 | | | | |
| | 02, 05 & 08 | M | | | | |
| | 04, 11, 12 & 18 | 1-6 | | | | |
| | 04 & 09 | 7 | | | | |
| | 01, 07, 08, 14, 15 & 21 | 2-4 | | | | |
| 01 & 21 | 3-6 | 1,009 | 96 | 1,105 | 24 | |
| | 01 & 12 | 7 | | | | |

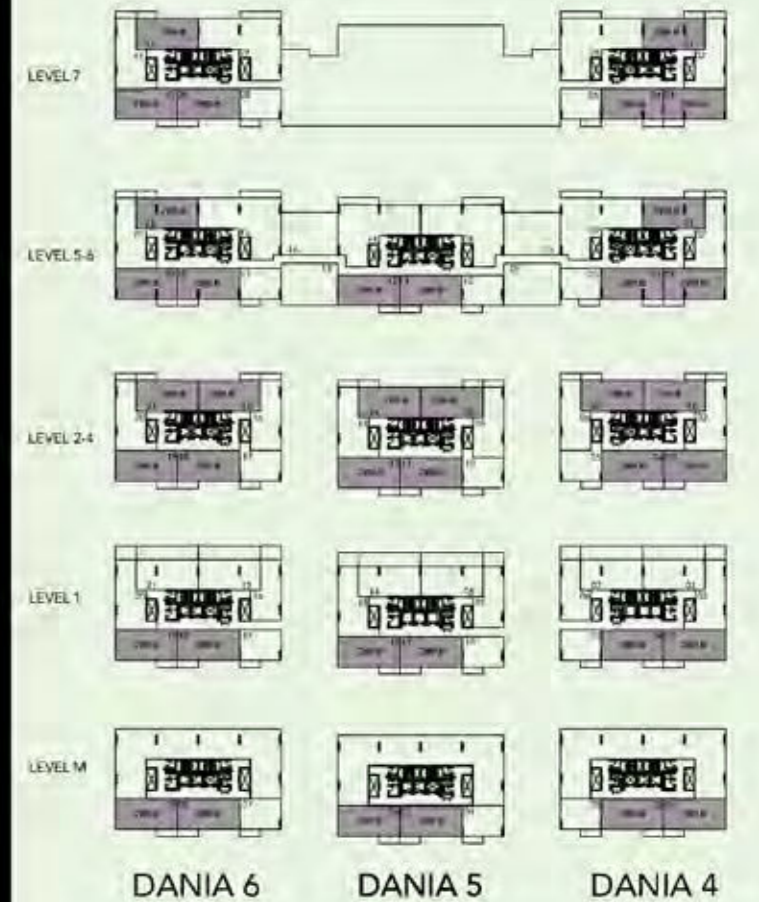
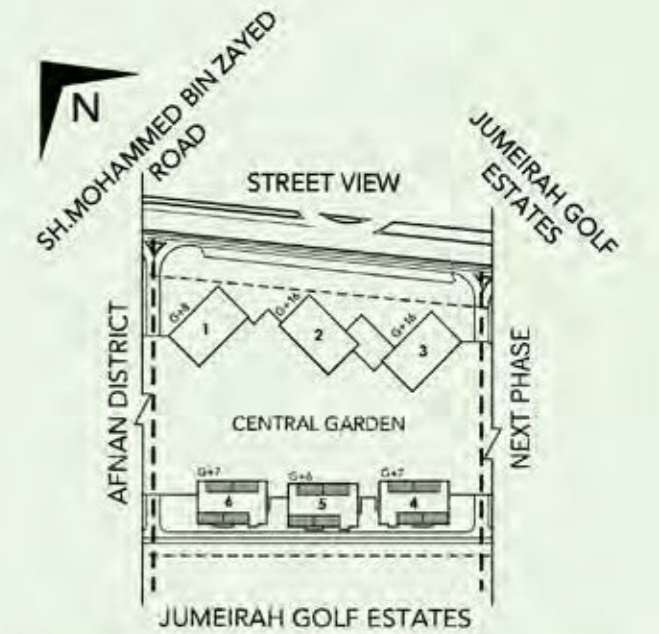

DANIA 6 DANIA 5 DANIA 4

DANIA 4, 5 & 6
TWO BEDROOM APARTMENT - TYPE C

2BR/C



| TYPE | UNIT NO. | LEVEL | UNIT (SQ.FT.) | BALCONY (SQ.FT.) | TOTAL (SQ.FT.) | TOTAL COUNT (NO.) |
|-------|-------------|-------|---------------|------------------|----------------|-------------------|
| 2BR/C | 06, 09 & 16 | 2-4 | 990 | 92 | 1,082 | 9 |

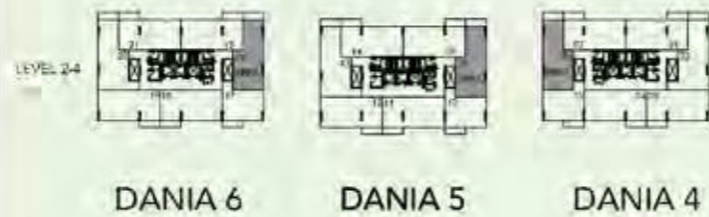
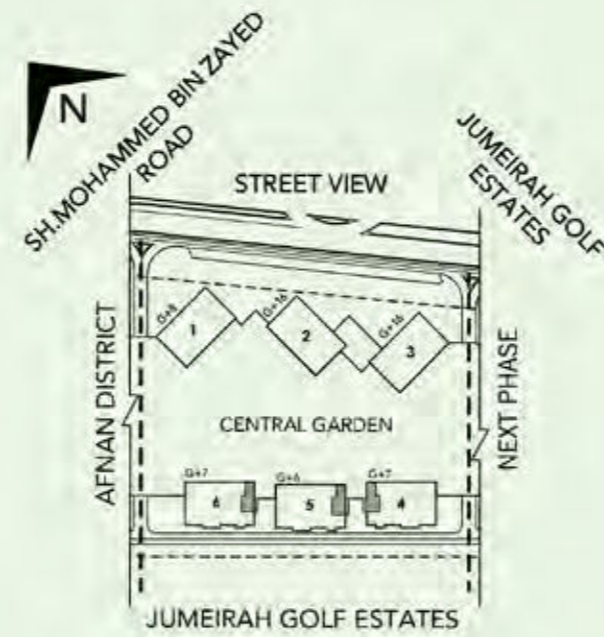

DANIA 4, 5 & 6
TWO BEDROOM APARTMENT - TYPE D

2BR/D



| TYPE | UNIT NO. | LEVEL | UNIT (SQ.FT.) | BALCONY (SQ.FT.) | TOTAL (SQ.FT.) | TOTAL COUNT (NO.) |
|-------|-------------|-------|---------------|------------------|----------------|-------------------|
| 2BR/D | 02, 11 & 20 | 2-4 | 1,046 | 92 | 1,138 | 15 |
| | 02 & 20 | 5-6 | | | | |
| | 02 & 11 | 7 | | | | |

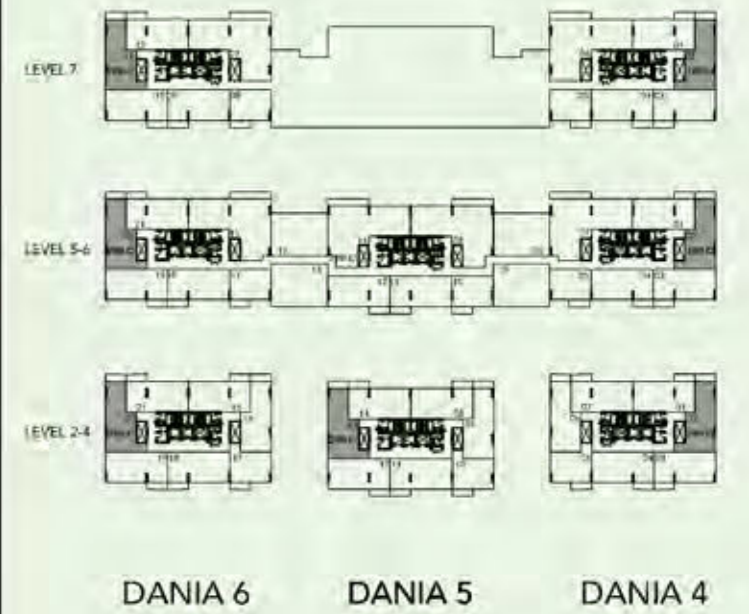
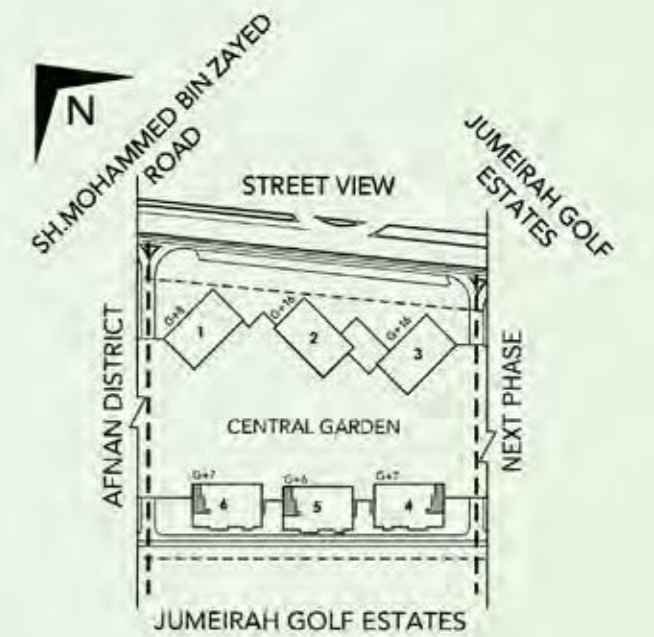

DANIA 4, 5 & 6
TWO BEDROOM APARTMENT - TYPE E

2BR/E



| TYPE | UNIT NO. | LEVEL | UNIT (SQ.FT.) | BALCONY (SQ.FT.) | TOTAL (SQ.FT.) | TOTAL COUNT (NO.) |
|-------|-------------|-------|---------------|------------------|----------------|-------------------|
| 2BR/E | 02, 13 & 20 | 1 | 1,046 | 150 | 1,196 | 3 |

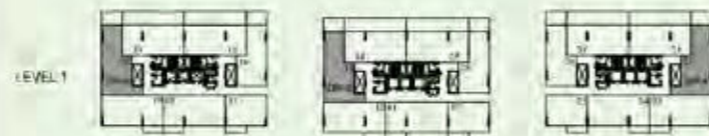
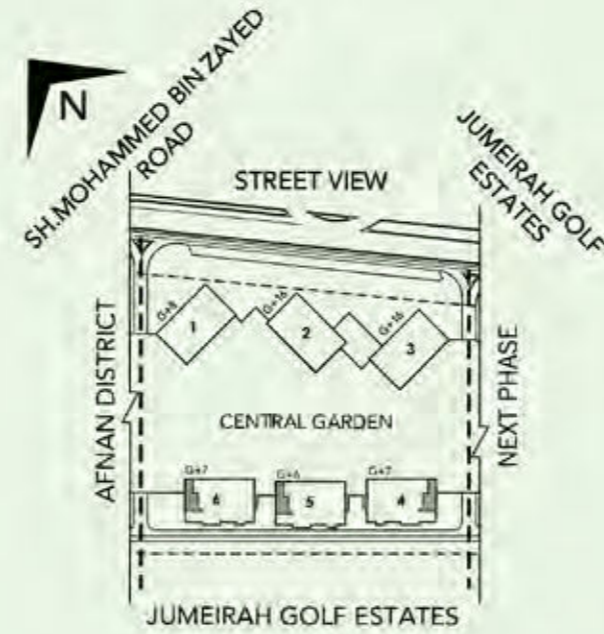

DANIA 6 DANIA 5 DANIA 4

DANIA 4, 5 & 6
TWO BEDROOM APARTMENT - TYPE F

2BR/F



| TYPE | UNIT NO. | LEVEL | UNIT (SQ.FT.) | BALCONY (SQ.FT.) | TOTAL (SQ.FT.) | TOTAL COUNT (NO.) |
|-------|-------------------------|-------|---------------|------------------|----------------|-------------------|
| 2BR/F | 01, 07, 08, 14, 15 & 21 | 1 | 1,009 | 461 | 1,470 | 6 |

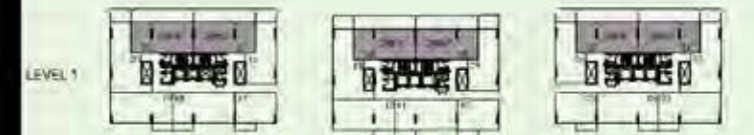
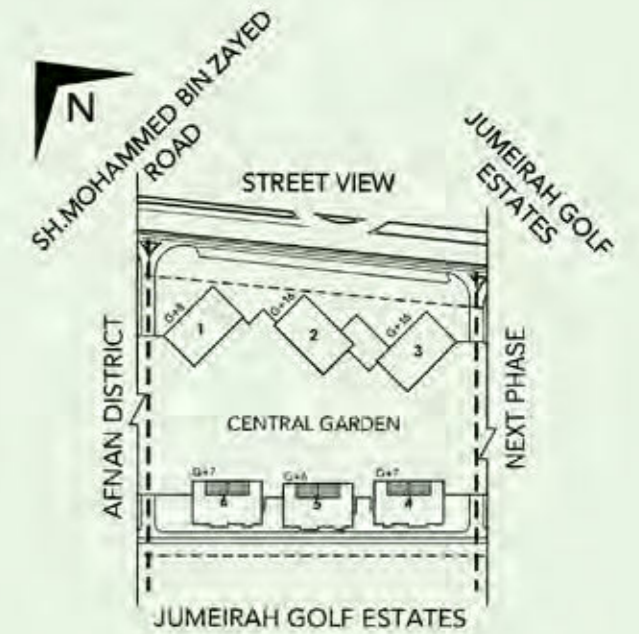

DANIA 6 DANIA 5 DANIA 4

DANIA 4, 5 & 6
TWO BEDROOM APARTMENT - TYPE G

2BR/G



| TYPE | UNIT NO. | LEVEL | UNIT (SQ.FT.) | BALCONY (SQ.FT.) | TOTAL (SQ.FT.) | TOTAL COUNT (NO.) |
|-------|----------|-------|---------------|------------------|----------------|-------------------|
| 2BR/G | 06 & 16 | 5-6 | 1,105 | 144 | 1,249 | 4 |
| 2BR/G | 09 & 13 | 5-6 | 1,134 | 120 | 1,254 | 4 |

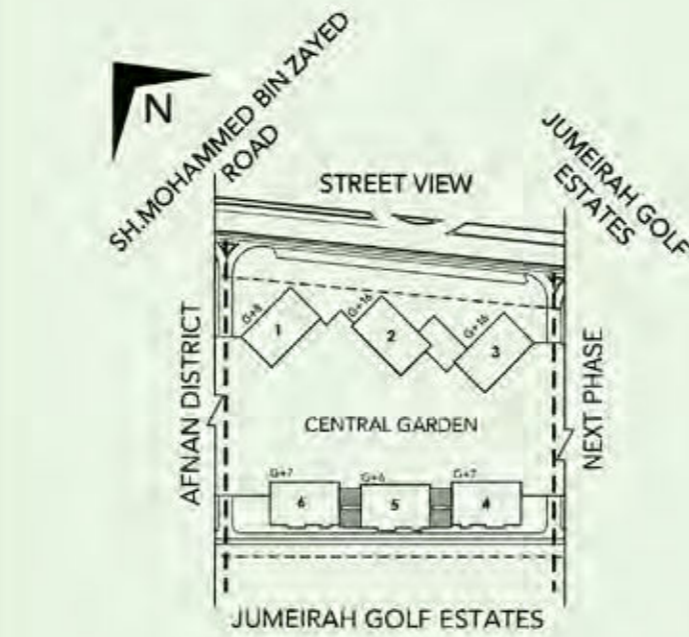

DANIA 4, 5 & 6
THREE BEDROOM APARTMENT - TYPE A

3BR/A



| TYPE | UNIT NO. | LEVEL | UNIT (SQ.FT.) | BALCONY (SQ.FT.) | TOTAL (SQ.FT.) | TOTAL COUNT (NO.) |
|-------|---------------|-------|---------------|------------------|----------------|-------------------|
| 3BR/A | 07,08,14 & 15 | 5-6 | 1,483 | 190 | 1,673 | 8 |
| | 06 & 07 | 7 | 1,484 | 187 | 1,671 | 2 |

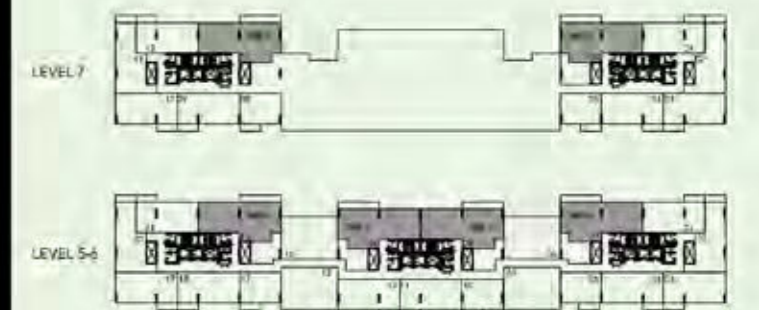
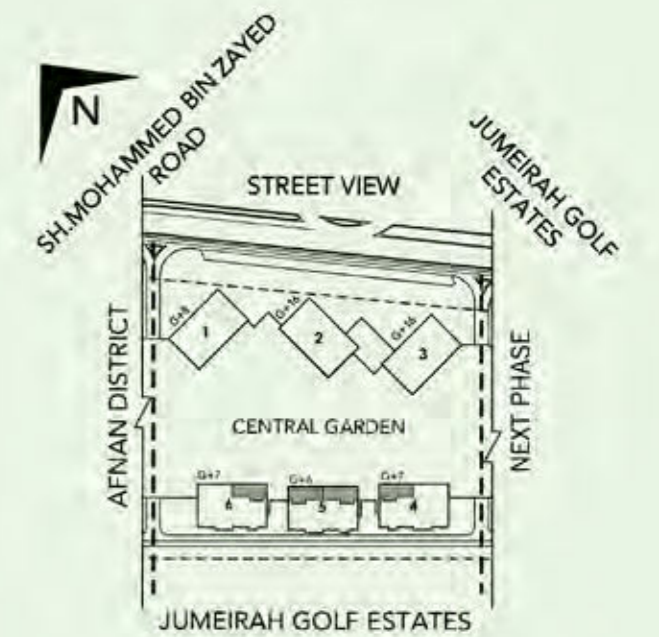

DANIA 6 DANIA 5 DANIA 4